

Product **Contacts: 8, female panel mount connector, dip-solder**

Area **Snap-in IP67 Series 620**  
Article number **99 9228 090 08**

### Illustration



### Scale drawing

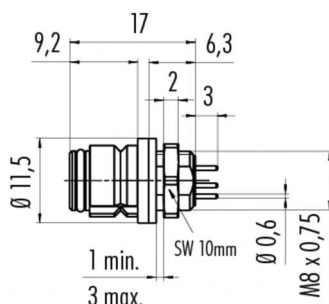

**You can find the assembly instruction on the next page.**

## Technical data

### General features

Connector Design	female panel mount connector
Connector locking system	snap
Termination	dip-solder
Upper temperature	85 °C
Lower temperature	-25 °C

### Electrical parameters

Rated current (40°C)	1 A
Rated voltage	63 V
Rated impulse voltage	800 V
Pollution degree	2
Overvoltage category	II
Material group	II
Volume resistivity	≤ 3 mΩ
Insulation resistance	≥ 10 <sup>10</sup> Ω
EMV compliance	Shielding is not possible
Degree of protection	IP67
Mechanical operation	> 500 Mating cycles

### Material

Material of contact	CuSn (bronze)
Contact plating	Au (gold)
Material of contact body	PA (UL 94 V-0)
Material of housing	PA

Product **Contacts: 8, female panel mount connector, dip-solder**

Area **Snap-in IP67 Series 620**  
Article number **99 9228 090 08**

Installation instructions / Mounting cutout

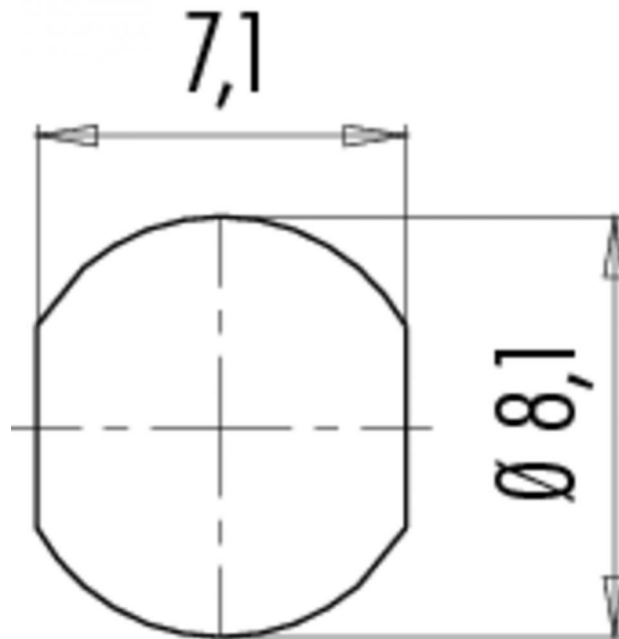

Product **Contacts: 8, female panel mount connector, dip-solder**

Area **Snap-in IP67 Series 620**  
Article number **99 9228 090 08**

## Security notices

The connectors are designed for use in plant, control system and electrical equipment. The end user is responsible for checking whether the connectors are suitable for use in other applications. Connectors with degree of protection IP 67 and IP 68 are not suitable for use under water. When used outdoors, the connectors must be separately protected against corrosion. For further information about IP degrees of protection refer to 'Technical support' in the Download Centre.